

**WTROC-G**

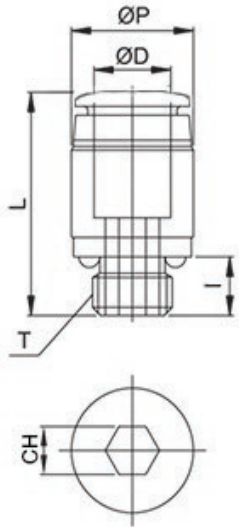

Male connector with internal hexagon metric thread nickel plated

CODE	ØD	T	I	L	ØP	CH	GR.
WTROC04M5	4	M5X0,8	3,8	20,1	10	2,0	5,2
WTROC04M6	4	M6X1	4,5	20,8	10	2,0	5,6
WTROC06M5	6	M5X0,8	3,8	21,0	12	2,0	6,8
WTROC06M6	6	M6X1	4,5	21,7	12	2,0	7,2

**WTROC-N**

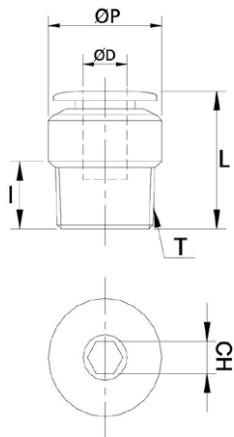

Male connector with internal hexagon NPT & UNF thread nickel plated

CODE	ØD	T	I	L	CH	H	LB
WTROC532UF1032	5/32	UNF 10-32	0,149	0,799	0,093	0,393	0,011
WTROC532N01	5/32	N1/8"	0,295	0,779	0,093	0,393	0,012
WTROC1-4UF1032	1/4	UNF 10-32	0,149	0,834	0,093	0,472	0,013
WTROC1-4N01	1/4	N1/8"	0,295	0,822	0,156	0,472	0,014
WTROC1-4N02	1/4	N1/4"	0,413	0,933	0,156	0,551	0,027
WTROC516N01	5/16	N1/8"	0,295	1,019	0,187	0,551	0,022
WTROC516N02	5/16	N1/4"	0,413	1,019	0,218	0,551	0,028
WTROC516N03	5/16	N3/8"	0,433	0,881	0,218	0,669	0,038
WTROC38N02	3/8	N1/4"	0,413	1,200	0,218	0,669	0,049
WTROC38N03	3/8	N3/8"	0,433	1,011	0,312	0,669	0,049
WTROC38N04	3/8	N1/2"	0,551	1,015	0,312	0,826	0,074
WTROC1-2N02	1/2	N1/4"	0,413	1,334	0,250	0,826	0,047
WTROC1-2N03	1/2	N3/8"	0,433	1,196	0,312	0,826	0,048
WTROC1-2N04	1/2	N1/2"	0,551	1,314	0,313	0,826	0,082

