

CD-12M

Male quick coupler BSPT, DN 4.2

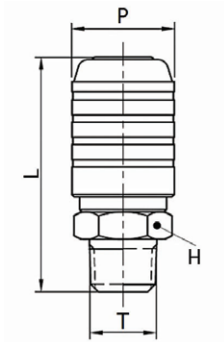

CODE	T	P	L	H
CD-12M1	R1/8"	20,5	45,5	17
CD-12M1-PL	R1/8"	20,5	45,5	17
CD-12M1-X	R1/8"	20,5	45,5	17
CD-12M1-X-PL	R1/8"	20,5	45,5	17
CD-12M	R1/4"	20,5	47,0	17
CD-12M-PL	R1/4"	20,5	47,0	17
CD-12M-X	R1/4"	20,5	47,0	17
CD-12M-X-PL	R1/4"	20,5	47,0	17

CD-12H

Female quick coupler BSPP, DN 4,2

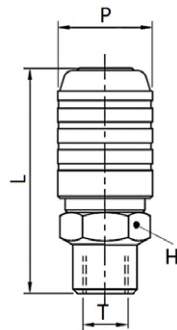

CODE	T	P	L	H
CD-12H	G1/4"	20,5	51,5	17
CD-12H-PL	G1/4"	20,5	51,5	17
CD-12H-X	G1/4"	20,5	51,5	17
CD-12H-X-PL	G1/4"	20,5	51,5	17
CD-12H1	G1/8"	20,5	48,5	17
CD-12H1-PL	G1/8"	20,5	48,5	17
CD-12H1-X	G1/8"	20,5	48,5	17
CD-12H1-X-PL	G1/8"	20,5	48,5	17

CD-12E

Quick coupler with barb connector DN 4,2

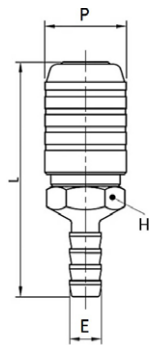

CODE	E	P	L	H
CD-12E6	7,2	20,5	58,5	17
CD-12E6-PL	7,2	20,5	58,5	17
CD-12ME6-X	7,2	20,5	58,5	17
CD-12ME6-X-PL	7,2	20,5	58,5	17
CD-12E8	9,2	20,5	58,0	17
CD-12E8-PL	9,2	20,5	58,0	17
CD-12E8-X	9,2	20,5	58,0	17
CD-12E8-X-PL	9,2	20,5	58,0	17

ACD-12M

Male connection BSPT, DN 4,2

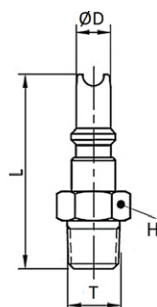

CODE	T	ØD	L	H
ACD-12M1	R1/8"	6,5	36,3	12
ACD-12M1-X	R1/8"	6,5	36,3	12
ACD-12M	R1/4"	6,5	38,3	14
ACD-12M-X	R1/4"	6,5	38,3	14

