

1834

Lateral reduced male tee BSPT thread

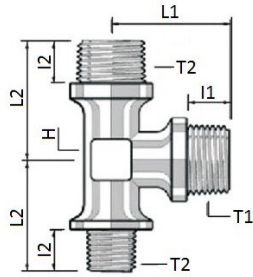

CODE	T1	T2	I1	I2	L1	L2	H	GR.
1834TR1814	R1/8"	R1/4"	8,0	10,0	20,0	21,0	12	5,0
1834TR1438	R1/4"	R3/8"	10,0	10,0	24,0	24,0	15	9,5
1834TR3812	R3/8"	R1/2"	10,0	12,5	29,5	31,0	17	19,0
1834TR1418	R1/4"	R1/8"	10,0	8,0	22,0	21,0	12	4,9
1834TR3814	R3/8"	R1/4"	10,0	10,0	24,0	24,0	15	8,8
1834TR1238	R1/2"	R3/8"	12,5	10,0	32,0	31,0	17	17,9

1840

M/F reducer BSPT thread

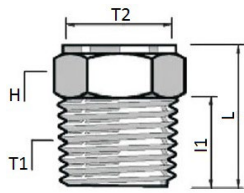

CODE	T1	T2	I1	L	H	GR.
1840TR1418	R1/4"	R1/8"	10,0	17,5	14	1,5
1840TR3818	R3/8"	R1/8"	10,5	17,5	17	2,7
1840TR3814	R3/8"	R1/4"	10,5	17,5	17	2,1
1840TR1218	R1/2"	R1/8"	12,5	20,5	22	6,0
1840TR1214	R1/2"	R1/4"	12,5	20,5	22	5,5
1840TR1238	R1/2"	R3/8"	12,5	20,5	22	3,8
1840TR3414	R3/4"	R1/4"	13,5	22,5	27	8,9
1840TR3438	R3/4"	R3/8"	13,5	22,5	27	8,1
1840TR3412	R3/4"	R1/2"	13,5	22,5	27	7,0

1850

M plug BSPT thread

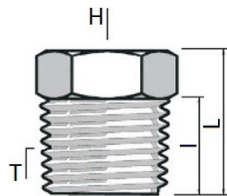

CODE	T	I	L	H	GR.
1850TR18	R1/8"	9,0	14,0	12	1,0
1850TR14	R1/4"	10,5	16,0	15	2,0
1850TR38	R3/8"	10,5	16,0	17	3,0
1850TR12	R1/2"	12,5	20,0	22	5,0
1850TR34	R3/4"	15,0	22,0	30	8,0
1850TR1	R1"	20,0	27,0	36	-

1855

Female plug BSPT thread

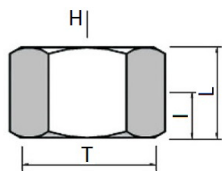

CODE	T	I	L	H	GR.
1855TR18	R1/8"	9,0	15,0	13	1,1
1855TR14	R1/4"	10,0	16,0	16	1,2
1855TR38	R3/8"	11,0	14,0	20	2,7
1855TR12	R1/2"	13,5	20,5	25	4,3
1855TR34	R3/4"	14,0	19,5	30	6,2

